

Storage Rack System

Sediment cores and samples from the deep-sea floor are an essential work basis for marine geologists.

For their preservation, storing and transport we designed our storage rack system comprising storage boxes and adequate sediment core storage tubes (d-tubes) as well as liner tubes.

The modular system is available with insertable grids, bottom and side grids for all types of sediment boxes. Each core segment is separately accessible.

The storage racks are designed for the transport in standard 20" containers and can be piled up to a maximum height of 6 meters



Grid box

Basic rack: *frame
*side grid, length or transverse wise
*2 insertable grids, length or transv. wise

Weight: appr. 60kg
Measure: 1653mm (l) x 1136mm (w) x 680mm (h)
Material: galvanised steel

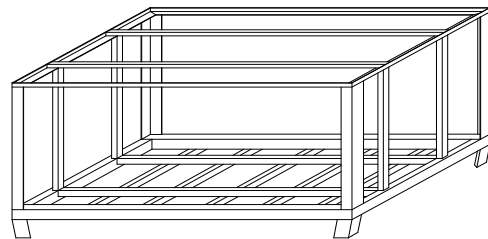

Sediment core storage tubes („D-Tubes“)

D-tubes are used for long term storing of sediment cores and protect them from contamination and moisture loss.

Sediment cores, mostly in cylindrical shape, are pressed into liner tubes. These are cut into two halves, one half each is then pushed into a d-tube.

A wet, synthetic sponge regulates the humidity.

Two types of d-tubes are available:
KR 135: 135mm (w) x 73mm (h)
KR 100: 100mm (w) x 55mm (h)
in different lengths.

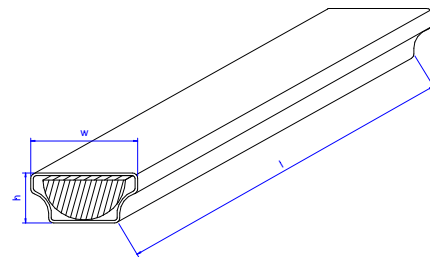

Synthetic sponge, D-Tube KR 135 and KR 100



K.U.M. Umwelt- und Meerestechnik Kiel GmbH

Wischhofstr. 1-3, Geb. 15, 24148 Kiel – Germany
Sitz der Gesellschaft / Registered Office: Kiel
Amtsgericht Kiel / Local Court Kiel, HRB 4773
Steuernummer / Tax No.: 20 291 07200

Geschäftsführer / General Manager: Thomas Kumbier – Uwe Arndt
USt-IdNr. / VAT No.: DE 812362272
Bankverbindung / Bank details: Förde Sparkasse
IBAN: DE39 2105 0170 0012 0028 20 – BIC: NOLADE21KIE

Storage Rack System

Liner tubes for cylindrical cores

The liner tube KL 125 is suitable for KR 135, the liner tube KL 90 for KR 100

Diameter KL 125: 125mm x 2,5mm

Diameter KL 90: 90mm x 2,7mm

Material: PVC; colour: grey

Accessories: lids for liner tubes

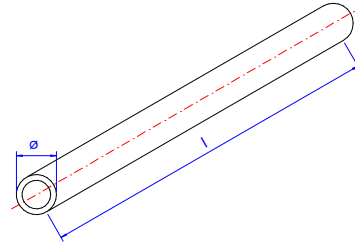

The d-tubes are delivered with two white lids.

Standard-lengths d-tubes: 1600mm, 1100mm, 1050mm – other lengths on request.

<u>Type</u>	<u>l x w x h (mm)</u>	<u>Material</u>	<u>Colour</u>	<u>Liner tube</u>
KR 135	1600 x 135 x 73	PVC	white	KL 125
	1100 x 135 x 73	PVC	white	KL 125
	1050 x 135 x 73	PVC	white	KL 125
KR 100	1600 x 100 x 55	PVC	white	KL 90
	1100 x 100 x 55	PVC	white	KL 90

Additional material: synthetic sponge & special glue